

SQUARE STAINLESS STEEL DOOR PULLS - 24" & 36" OVERALL

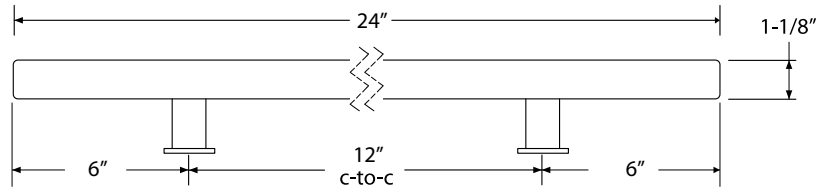

24" Square Door Pull  
**86191**

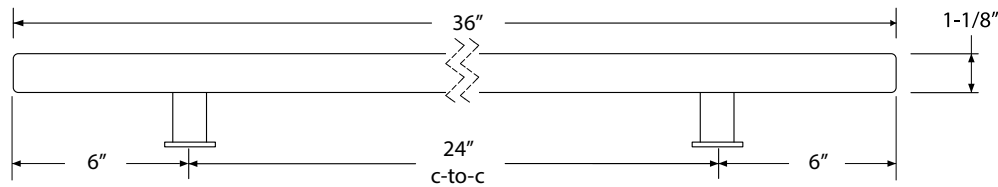
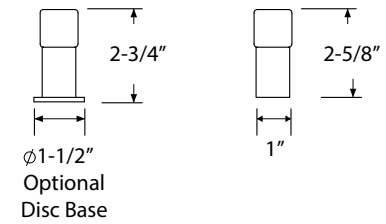

36" Square Door Pull  
**86192**

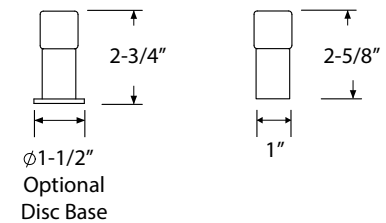

Standard Mounting

Thru-Bolt with  
Decorative Caps

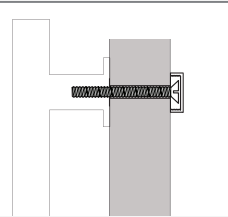

Optional Mounting

Concealed Surface  
CS

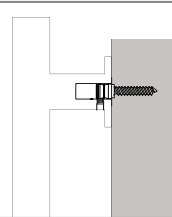

Back to Back  
**BTB**

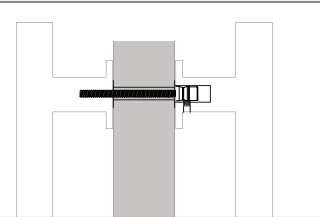

Fits Door Thickness: 1-3/4" to 2-1/4". Specify if thicker.

NOT DRAWN TO SCALE

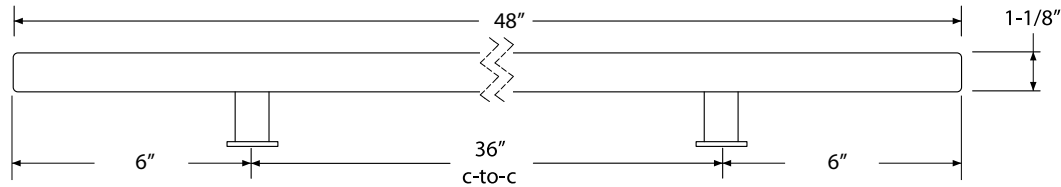

48" Square Door Pull  
**86187**

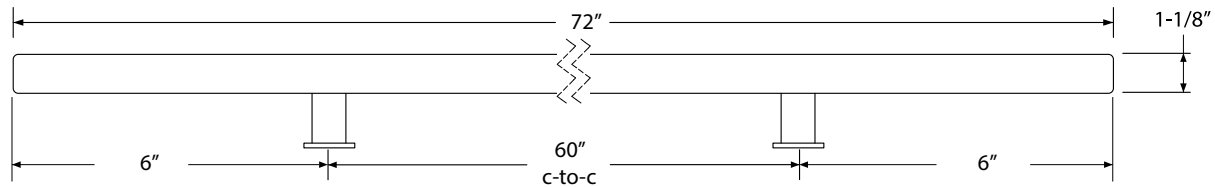
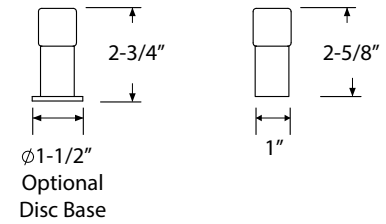

72" Square Door Pull  
**86188**

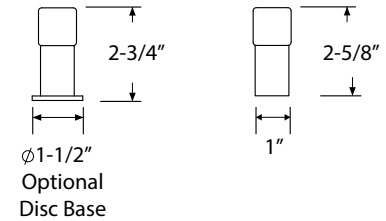

Standard Mounting

Thru-Bolt with  
Decorative Caps

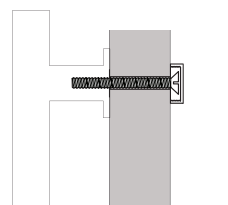

Optional Mounting

Concealed Surface  
CS

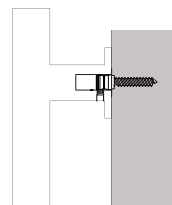

Back to Back  
**BTB**

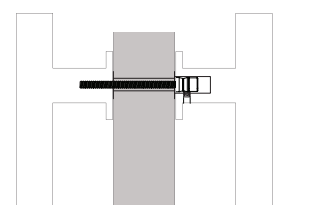

Fits Door Thickness: 1-3/4" to 2-1/4". Specify if thicker.

NOT DRAWN TO SCALE

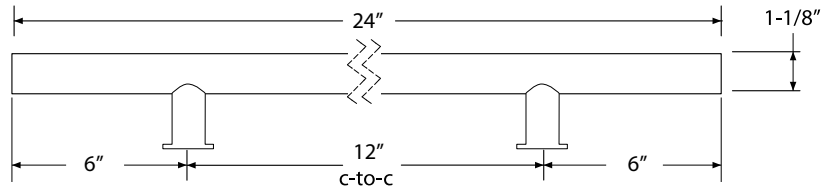

24" Round Door Pull  
**86193**

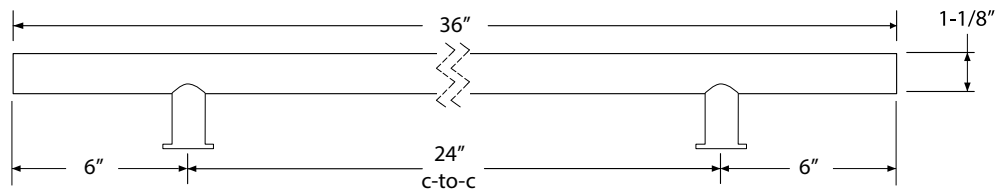
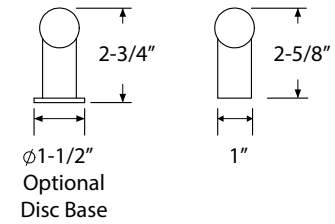

36" Round Door Pull  
**86194**

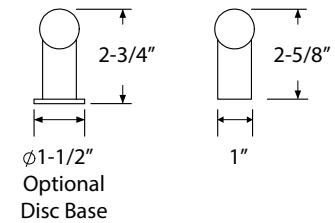

Standard Mounting

Thru-Bolt with  
Decorative Caps

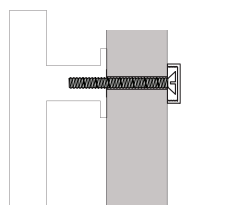

Optional Mounting

Concealed Surface  
CS

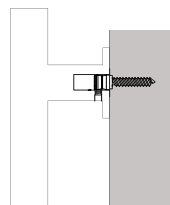

Back to Back  
**BTB**

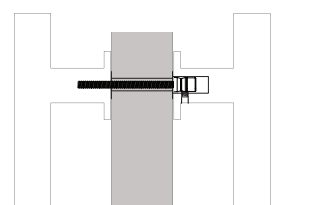

Fits Door Thickness: 1-3/4" to 2-1/4". Specify if thicker.

NOT DRAWN TO SCALE

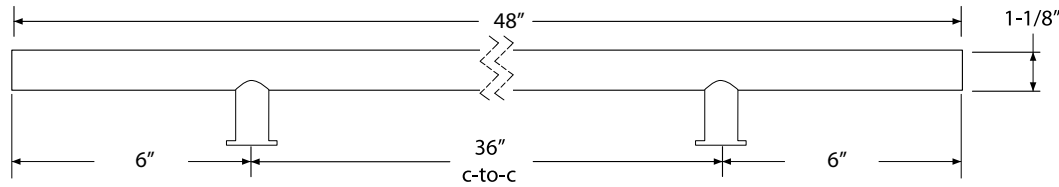

48" Round Door Pull  
86189

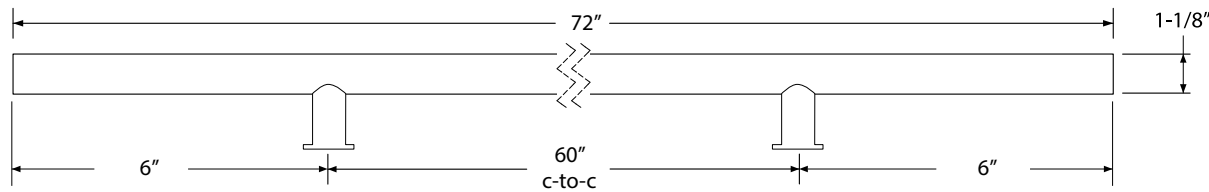
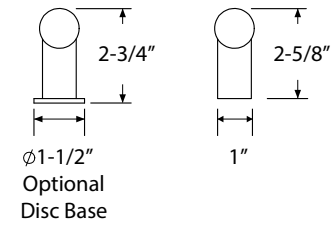

72" Round Door Pull  
86190

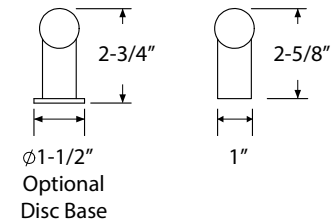

Standard Mounting

Thru-Bolt with  
Decorative Caps

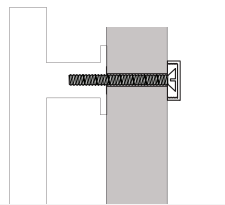

Optional Mounting

Concealed Surface  
CS

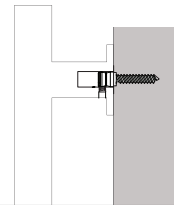

Back to Back  
BTB

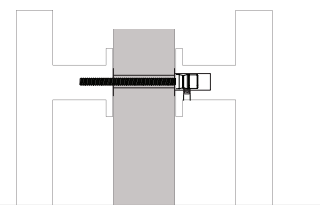

Fits Door Thickness: 1-3/4" to 2-1/4". Specify if thicker.

NOT DRAWN TO SCALE